

Hotel Pineta Palace



NANA

MAXIMUM CAPACITY (SETS)

Board room table:	20
-------------------	----

DIMENSIONS:

Total area:	sqm	45,00
Width max:	mt	6,10
Length max:	mt	7,60
Height:	mt	2,75
Inside doors of access:	L x H	1,60 x 2,10 mt

OTHER EQUIPMENT'S AND SERVICES (over the general ones):

Other available services on request

IDEAL FOR:

Small Meetings

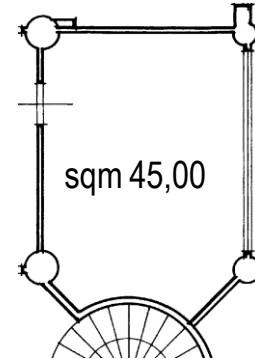

The Nana meeting room is the most suitable space for business meetings and small conferences and is available with a large round table. Its size of 45 square meters provides an environment sufficiently large but extremely private. Also available for private business dinners.

Technical equipment:

- Microphone with and without wire;
- screen and video projector
- flip chart;
- possibility of connection of audio and video sources through a mobile amplification system.

